



# **Cellular Mobile Telephone (Portable type)**

**Einbauanleitung - Installation Manual - Manuel d'installation**

---

## **GS 300 / GS 430**

**\*ZS16\* Series - Vehicle production date: August 2000**  
**MMC**

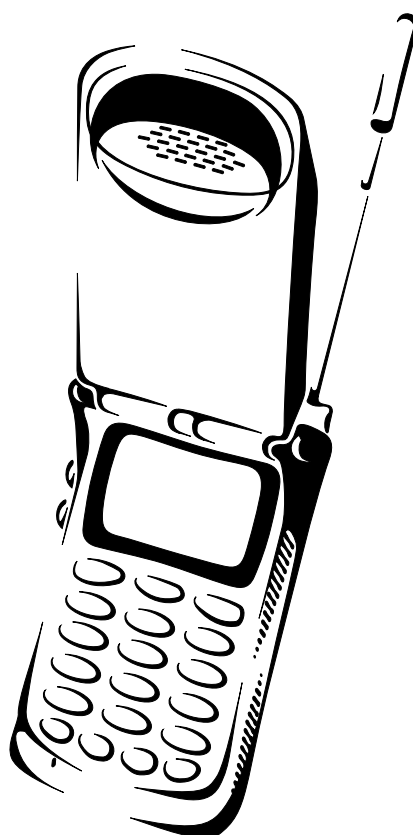

---

## Preface

This manual describes the installation method of the GSM-type Cellular Mobile Telephone (portable type) in Lexus GS 300 / GS 430 vehicles; model code ZS16 (since Aug. 2000).

For full installation the following part numbers are required:

Main kit PZ409-S1274-00

Subkit 86075-30071

### IMPORTANT!

#### Compulsory instructions for use

This GSM telephone is only allowed by the Toyota Motor Company to be installed in a Lexus motor vehicle and to be operated only within the normal use of this vehicle. It should not be operated in any other system installation.

## Table of Contents

|  |    |
|--|----|
| Preface .....                                    | 31 |
| Table of Contents .....                          | 33 |
| Lexus Telephone System Overview .....            | 34 |
| Pre-Installation Instructions .....              | 35 |
| Contents List      Main Kit PZ409-S1274-00 ..... | 36 |
| Subkit 86075-30071 .....                         | 37 |
| 1. Command Module Installation .....             | 38 |
| 2. Microphone Installation .....                 | 41 |
| 3. Portable Phone Installation .....             | 46 |
| 4. PSE Installation .....                        | 54 |
| 5. Steering Wheel Switch Mode Setting.....       | 57 |
| 6. Reassembly .....                              | 58 |
| 7. Putting into Service .....                    | 58 |

## Lexus Telephone System Overview

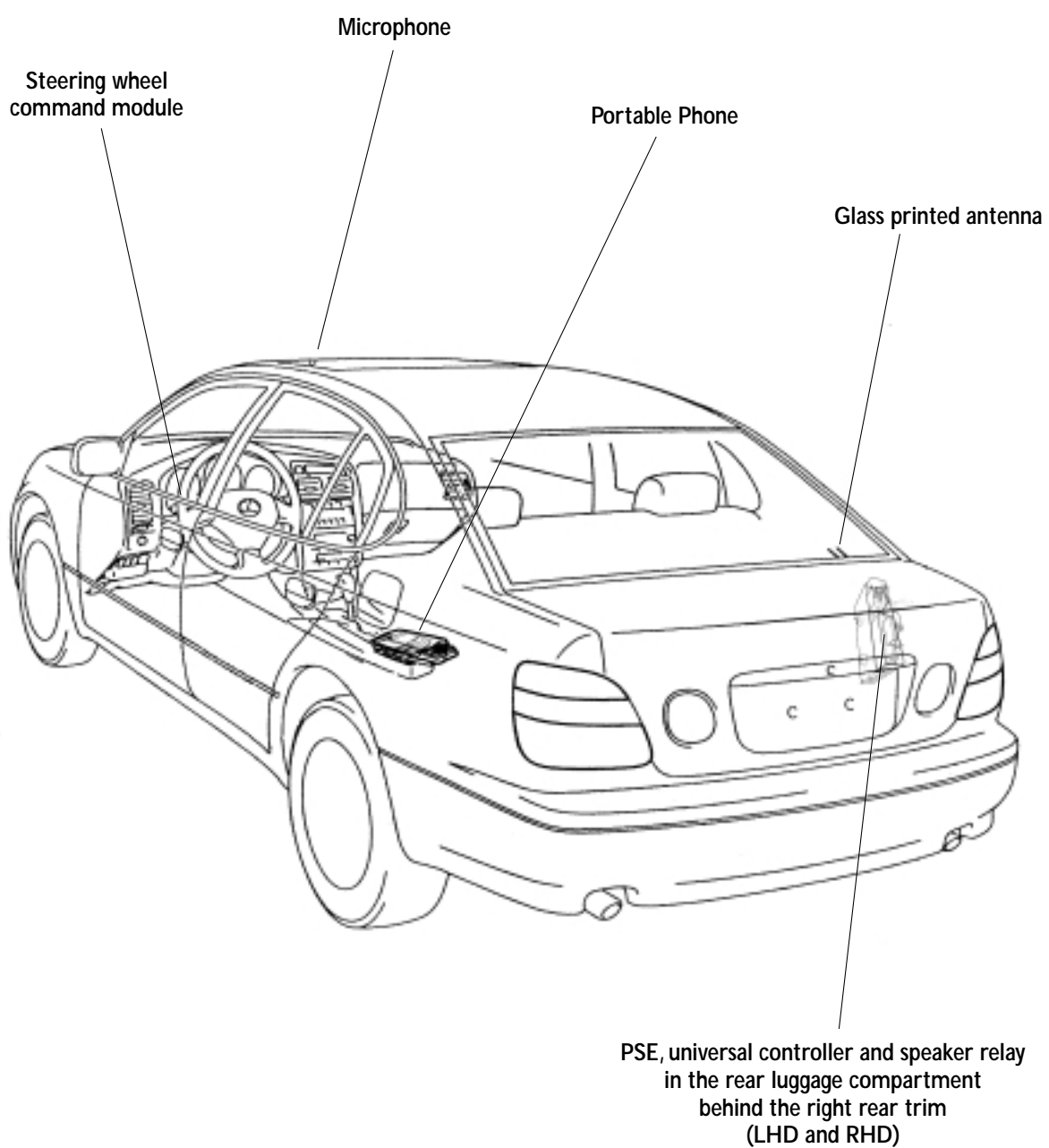

---

## Pre-Installation Instructions

1. **Ensure the Radio Security Code is available** and disconnect the negative (-) lead from the battery terminals.

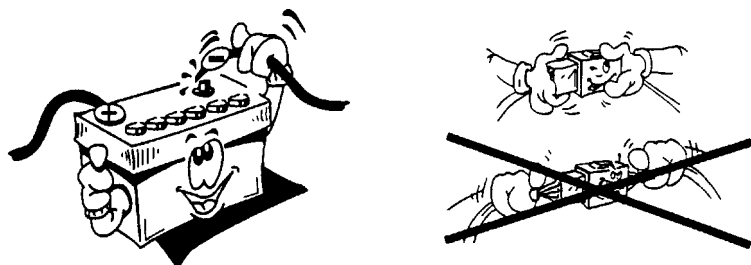

2. Protect Rear Right side fender and seats with covers.
3. When disconnecting connectors, be sure to grip the connector body. Do not tug on the wiring.
4. If further information is required and for trouble shooting, please refer to the Lexus Workshop Manual and the Electrical Wiring Diagram Manual EWD 317Y.

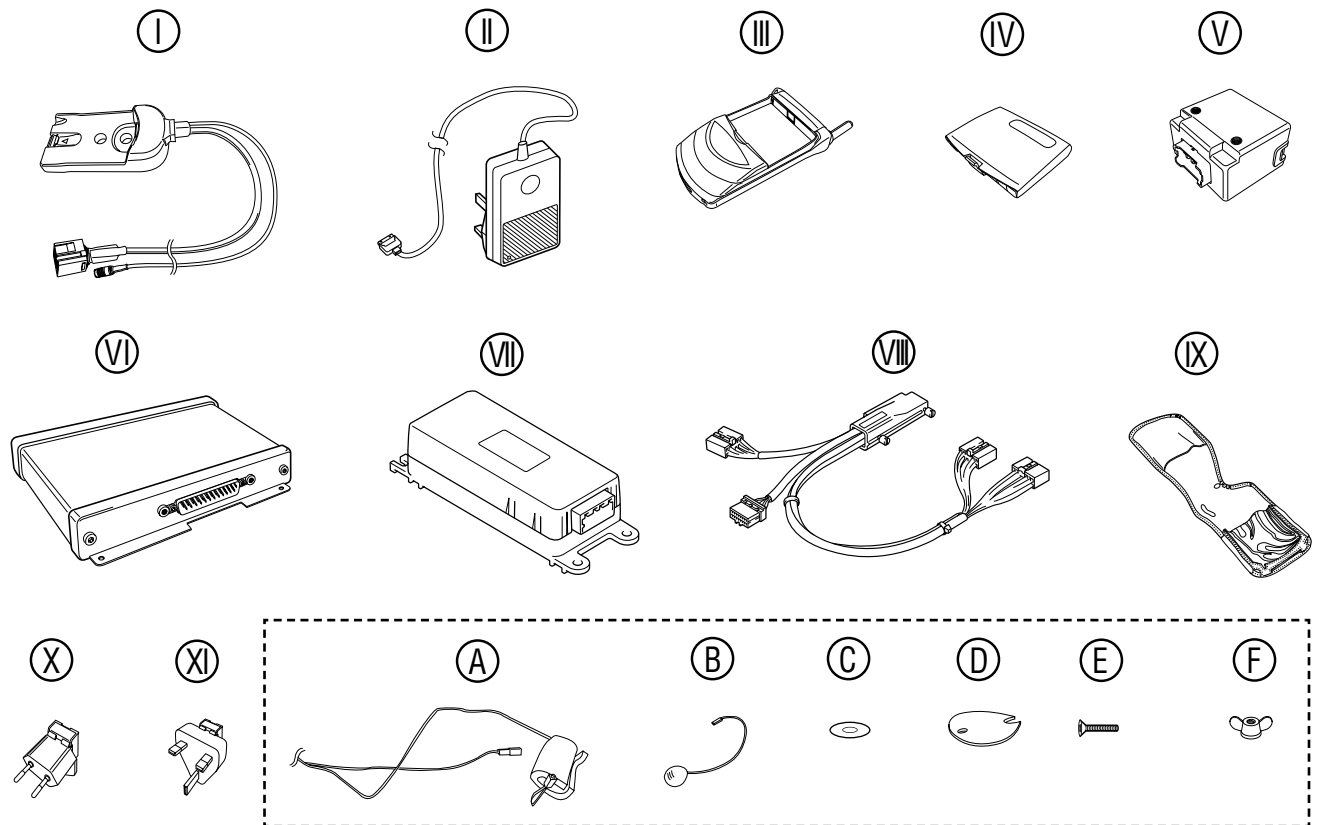

| No.  | Part Name                          | Part No.    | Qty |
|------|------------------------------------|-------------|-----|
| I    | Cradle                             | 86722-0W040 | 1   |
| II   | Battery charger                    | 86771-0W050 | 1   |
| III  | Handset                            | 86770-0W050 | 1   |
| IV   | Rechargeable battery               | 86725-0W050 | 1   |
| V    | Speaker relay                      | 86162-0W010 | 1   |
| VI   | PSE (Portable Support Electronics) | 86714-0W030 | 1   |
| VII  | Universal controller               | 86714-0W040 | 1   |
| VIII | 25P Subwire adapter cable          | 86713-0W160 | 1   |
| IX   | Leather case                       | 86778-0W020 | 1   |
| X    | Mainland Europe adapterplug        | 86771-0W060 | 1   |
| XI   | UK adapter plug                    | 86771-0W070 | 1   |
| A    | Microphone amplifier               | —           | 1   |
| B    | Microphone (assy)                  | 86730-0W150 | 1   |
| C    | Washer                             | —           | 1   |
| D    | Base                               | —           | 1   |
| E    | Screw                              | —           | 1   |
| F    | Nut                                | —           | 1   |

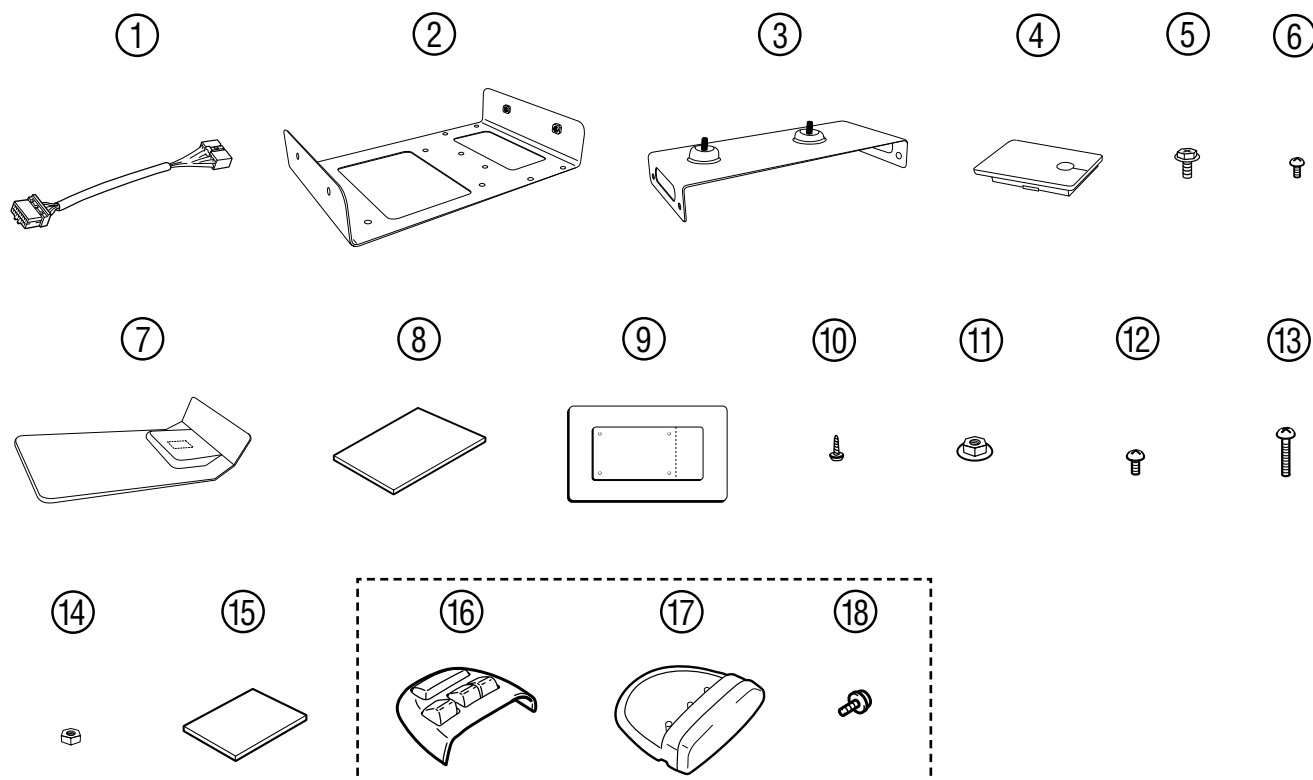

| No. | Part Name                           | Part No.    | Qty |
|-----|-------------------------------------|-------------|-----|
| ①   | Conversion wire                     | 86713-30050 | 1   |
| ②   | Main bracket                        | _____       | 1   |
| ③   | Support bracket                     | _____       | 1   |
| ④   | Grommet                             | 86726-30190 | 2   |
| ⑤   | Hexagonal bolt (M5x6)               | _____       | 4   |
| ⑥   | Bolt (M4x5) (for speaker relay)     | _____       | 2   |
| ⑦   | Telephone tray                      | _____       | 1   |
| ⑧   | Foam (large) (85x120)               | _____       | 1   |
| ⑨   | Template                            | _____       | 1   |
| ⑩   | Screw (tapping)                     | _____       | 4   |
| ⑪   | Nut (M6)                            | _____       | 2   |
| ⑫   | Bolt (M4x6) (for cradle)            | _____       | 4   |
| ⑬   | Bolt (M4x12) (for PSE)              | _____       | 8   |
| ⑭   | Nut (M4) (for universal controller) | _____       | 8   |
| ⑮   | Foam (small) (60x75)                | _____       | 10  |
| ⑯   | Command module switch cover         | 86174-48010 | 1   |
| ⑰   | Command module                      | 86750-48010 | 1   |
| ⑱   | Bolt (for command module)           | _____       | 2   |

# 1. COMMAND MODULE INSTALLATION

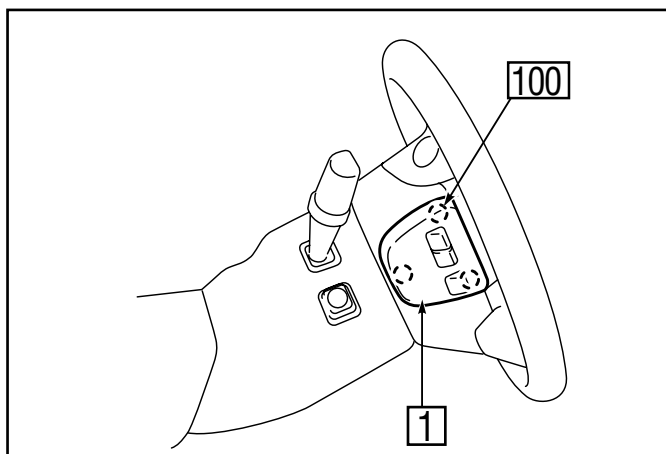

## FOR GS 430

- 1.1 Remove the steering wheel cover 1 from the steering wheel.

100: Hook (3x)

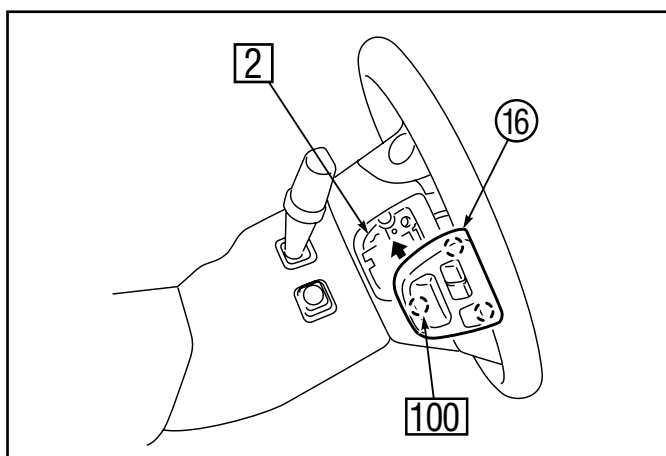

- 1.2 Fit the command module switch cover 16 to the secured command module base 2.

100: Hook (3x)

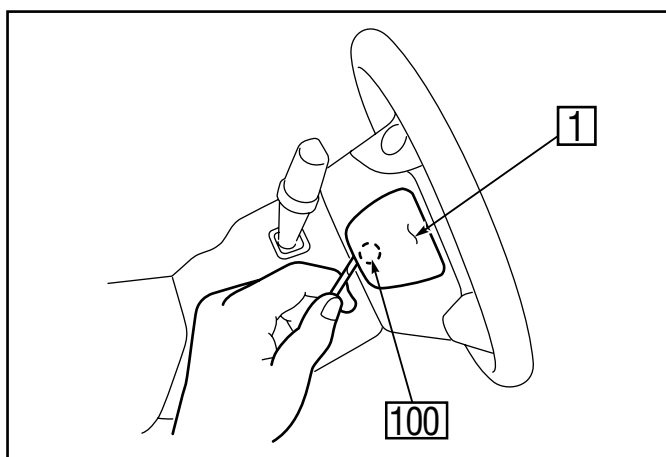

## FOR GS 300

- 1.3 Remove the steering wheel cover 1 from the steering wheel.

100: Hook (1x)



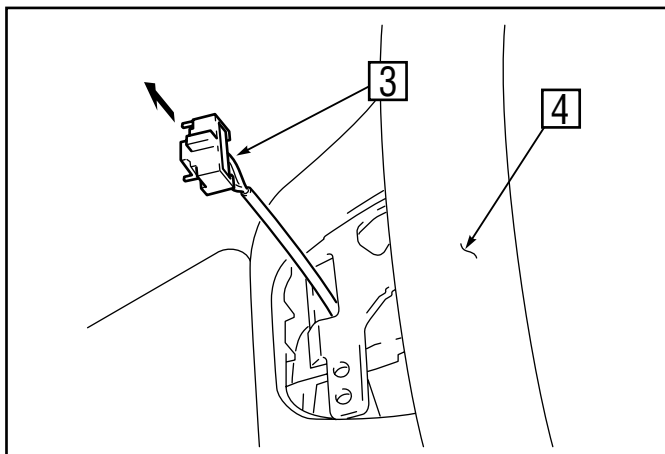

1.4 Pull the 6P connector 3 out of the steering wheel 4.

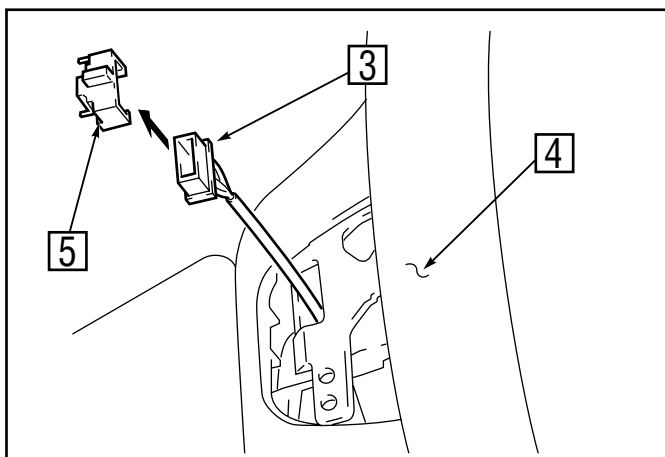

1.5 Remove the dummy connector cap 5 from the 6P connector 3.

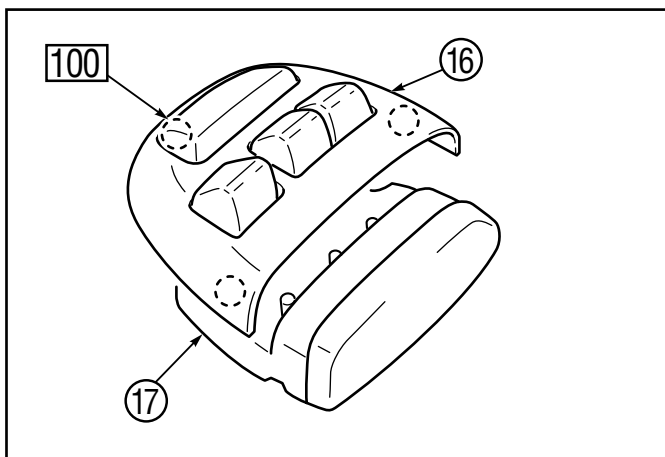

1.6 Remove the command module switch cover 16 from the command module 17.

100: Hook (3x)

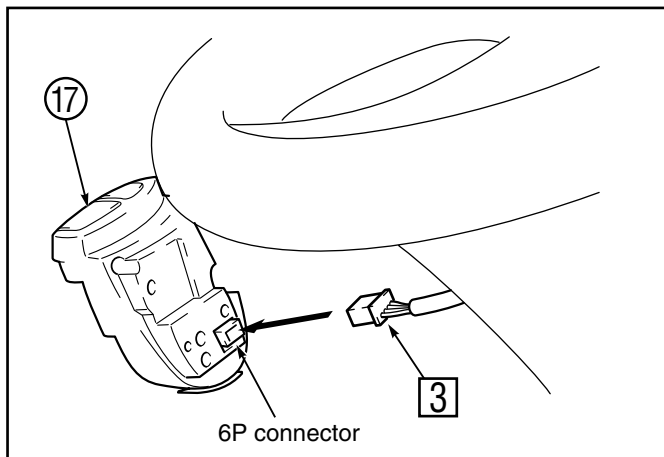

- 1.7 Connect the vehicle wire harness 6P connector 3 to the command module 6P connector.

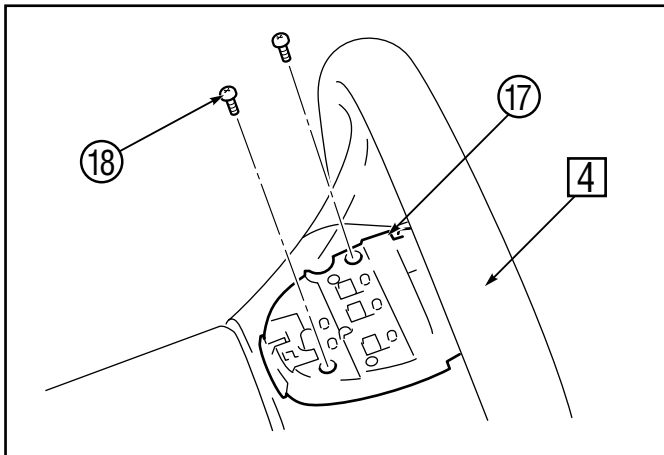

1.8

- a) Install the vehicle wire harness 6P connector 3 with the command module 17 as one assembly onto the steering wheel 4 and secure using bolts 18.

18: Bolt (2x)

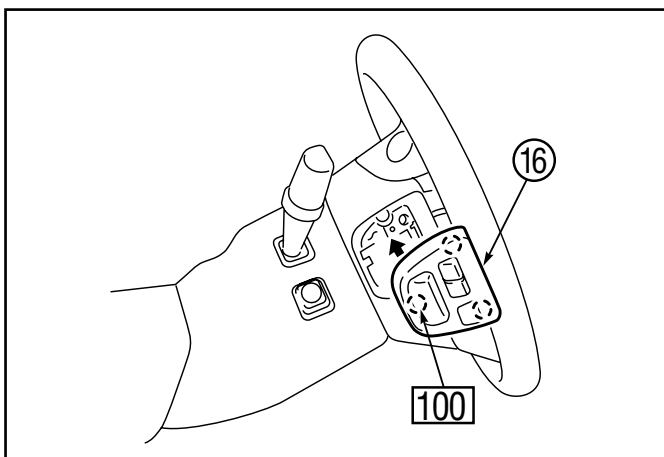

- 1.9 Fit the command module switch cover 16 to the secured command module base.

100: Hook (3x)

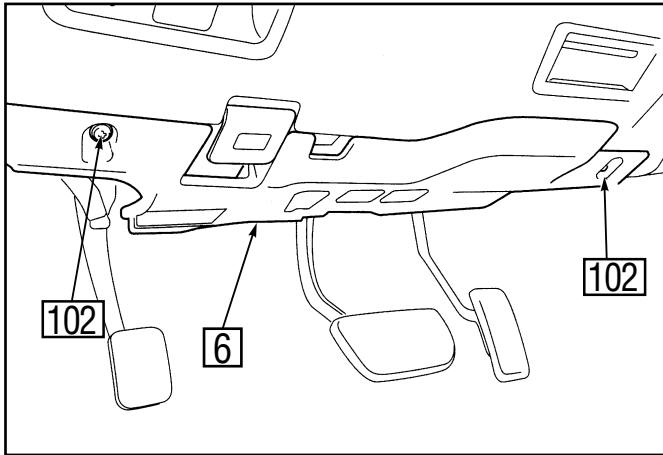

- 2.1 Remove the instrument lower cover 6 by removing the two Phillips screws 102 at far-left and far-right ends of the cover.

102: Screw (2x)

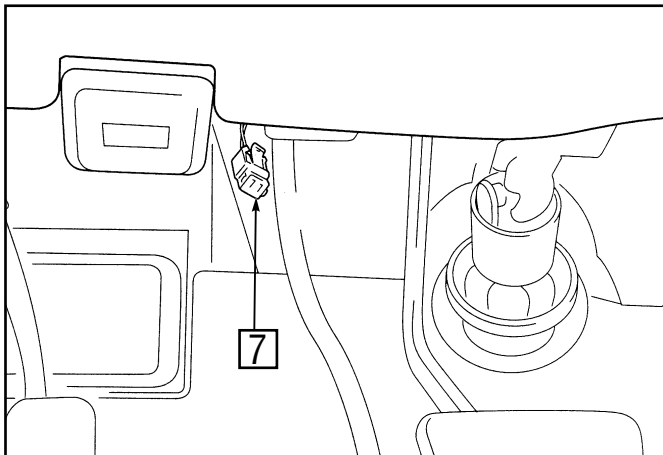

- 2.2 Locate the existing 2P connector for the microphone 7.

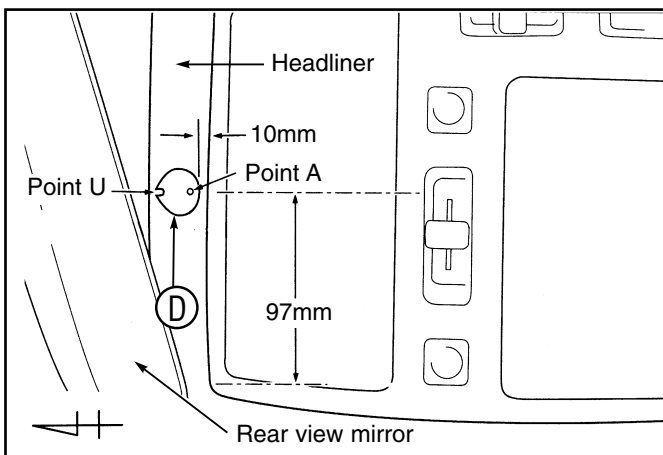

- 2.3

- Centre and position the microphone base D on the headliner 10mm from the control panel as shown.
- Mark point A, then mark point U on the headliner.

FOR RHD: MIRROR VIEW

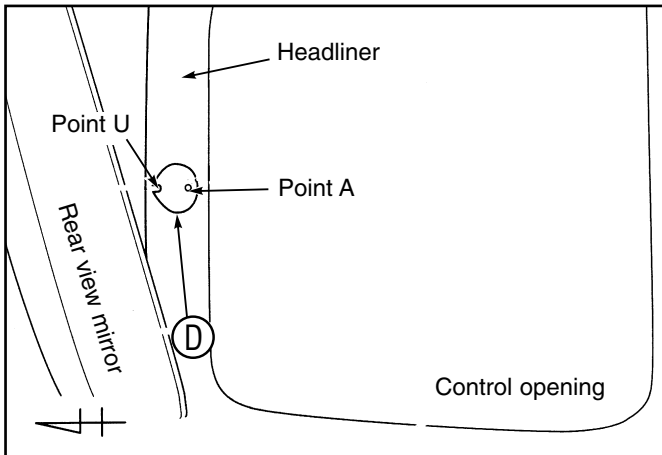

FOR RHD: MIRROR VIEW

#### 2.4

- a) As previously marked in step 2.3, punch a hole with an awl at point A.
- b) Drill a Ø6mm hole at point U.

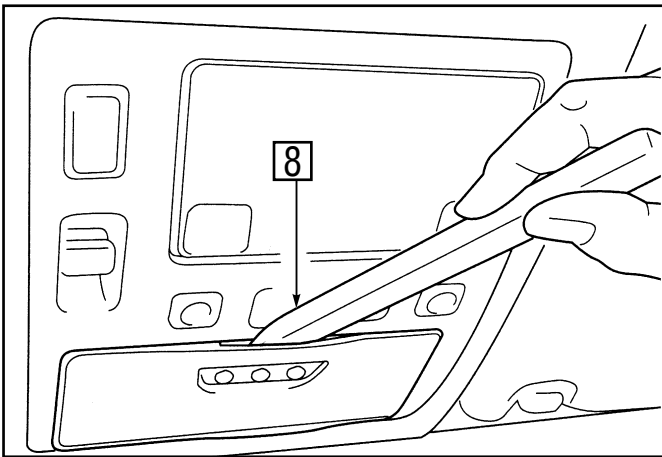

- 2.5 Lever down the overhead module door 8 at the point shown.

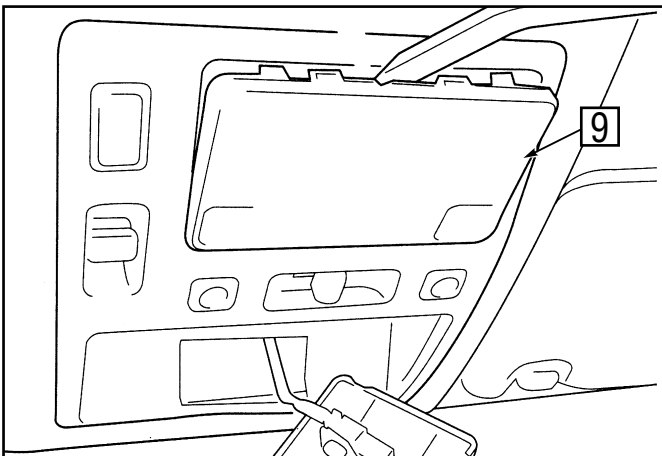

- 2.6 Lever off the map light lens cover 9 at the point shown.

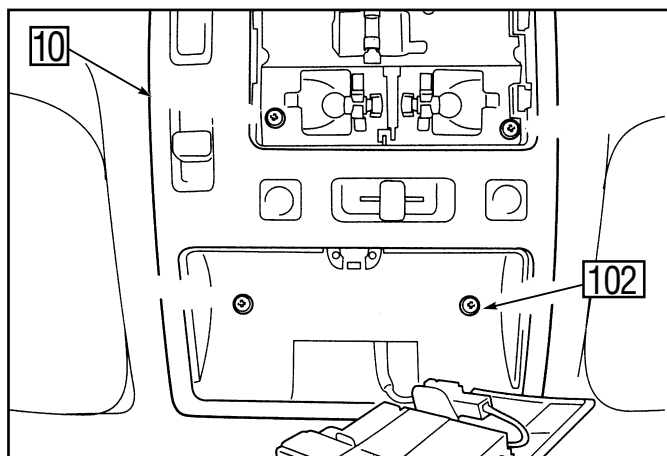

- 2.7 Remove the 4 Phillips screws **102** from the overhead module **10**. Detach and remove the overhead module **10**.

**102**: Screw (4x)

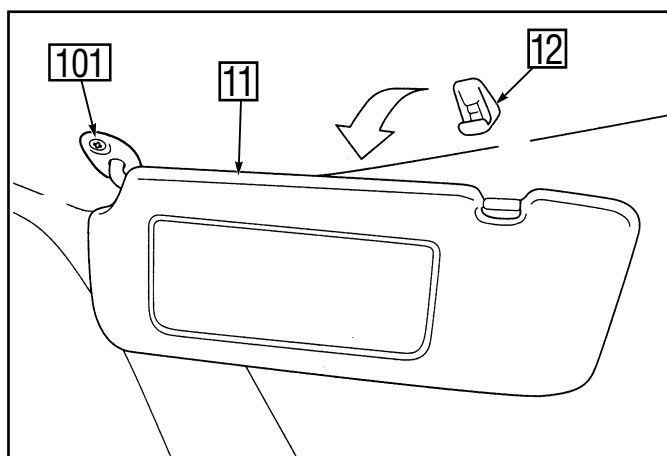

- 2.8

- a) Slide off the base cover **11** of the driver's side sun visor and detach the sun visor by removing the 2 screws **101**.

**101**: Screw (2x)

- b) Disconnect the vanity light connector.  
c) Remove the sun visor holder **12** by removing one screw and by levering down.

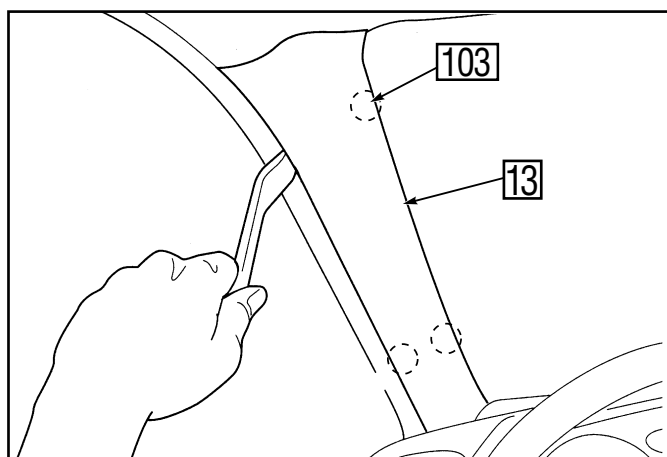

- 2.9 Lever off the "A" pillar cover **13**.

**103**: Clip (3x)

FOR RHD: MIRROR VIEW

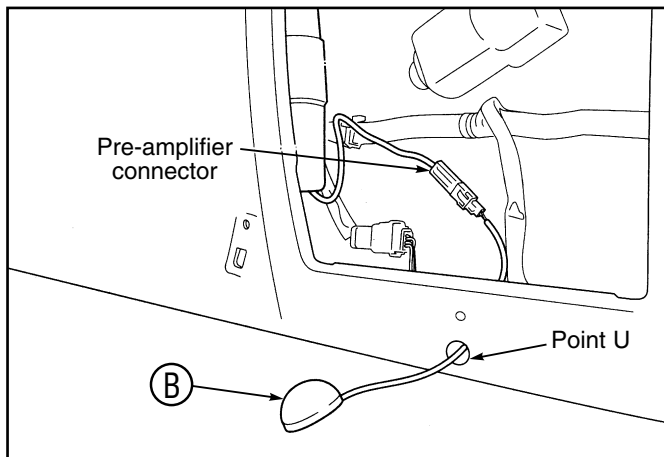

2.10

- a) Gently pull the front edge of the headliner down taking care not to cause stress marks.
- b) Push the microphone (B) connector through the headliner at point U and mate with the pre-amplifier connector.

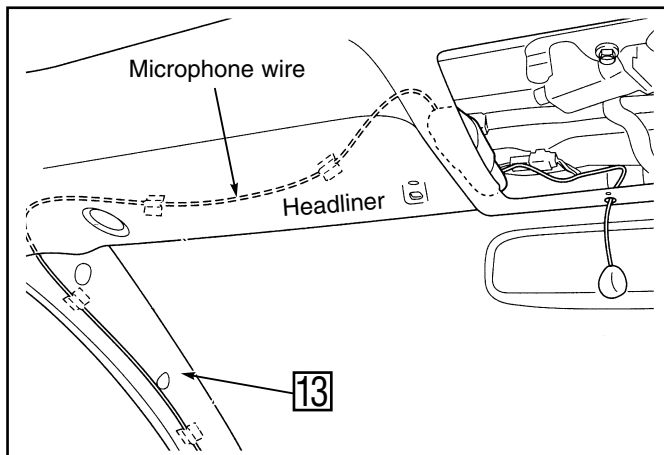

- c) Position the microphone pre-amplifier then tape to the headliner as shown.
- d) Route the microphone wire behind the headliner and along the driver's side "A" pillar 13, securing with tape.

FOR RHD: MIRROR VIEW

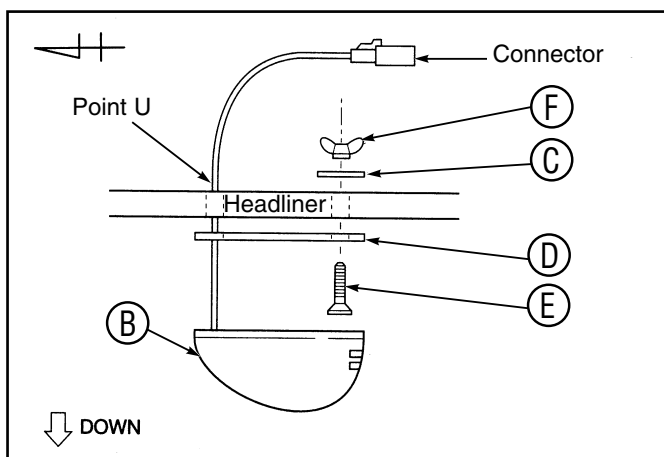

2.11

- a) Snap the microphone (B) to the base (D) so that the "Outside"-marked face contacts the headliner.
- b) Secure the microphone-base assembly to the headliner with screw (E), washer (C) and wing nut (F).

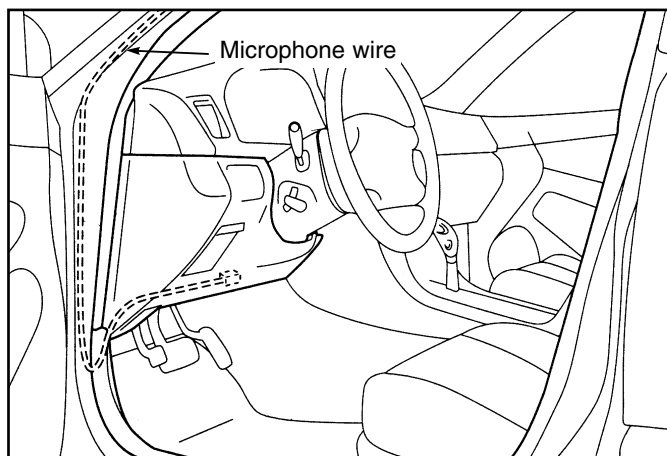

FOR RHD: MIRROR VIEW

- 2.12 Route the microphone wire down behind the dash and along the bottom of the underdash cover.

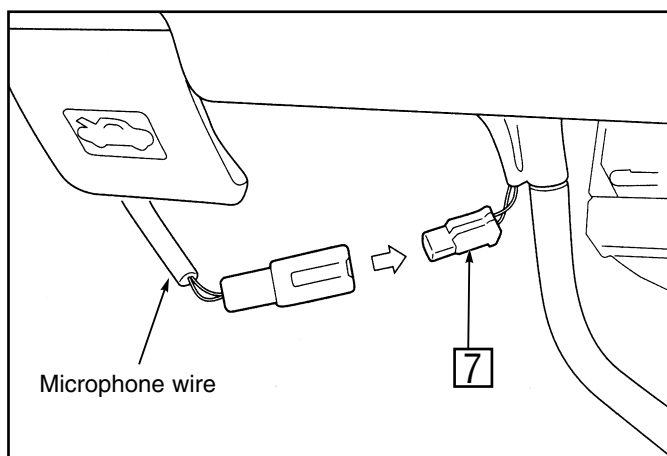

- 2.13 Connect the microphone wire to the existing 2P connector 7 as located in step 2.2.

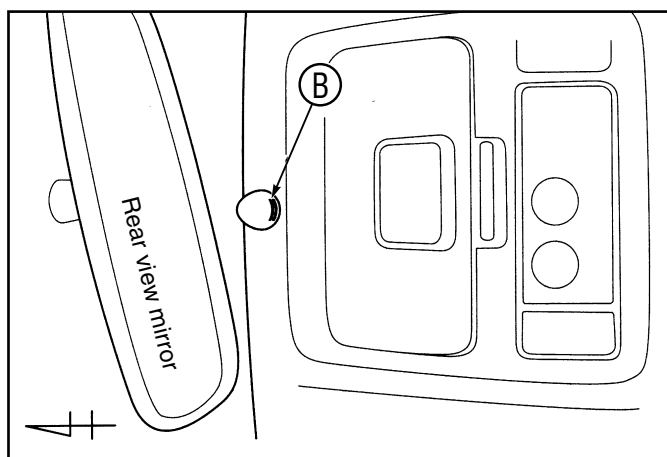

- 2.14 Replace all panels and fasteners in the correct locations. Ensure the headliner is properly replaced. Ensure that the sun visor, vanity lights, interior lights and sliding windows are working properly.

### 3. PORTABLE PHONE INSTALLATION

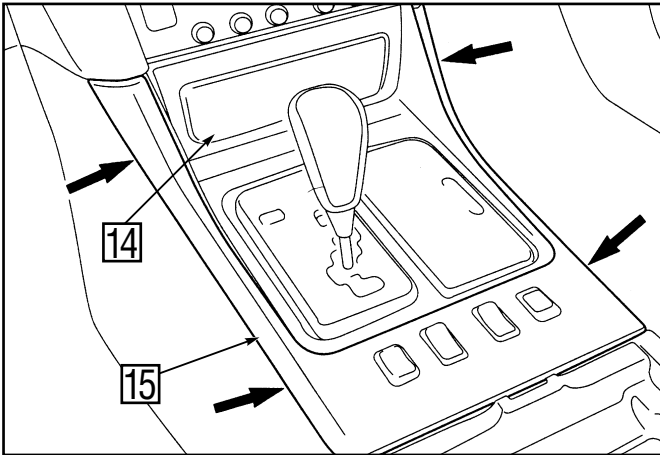

3.1

- a) Remove the ash tray **14**.
- b) Lever off the gear shift trim panel **15** at the 4 points shown.
- c) Disconnect the three connectors and remove the panel.

**HINT :**

**Lift the panel starting from the rear, then pull backwards after disconnecting the connectors.**

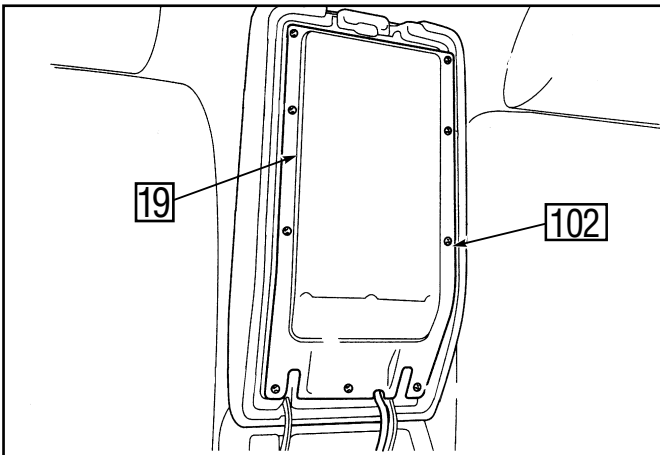

- 3.2 Raise the arm rest, remove the 9 Phillips screws **102** from the arm rest tray cover **19**, and remove the cover.

**102**: Screw (9x)

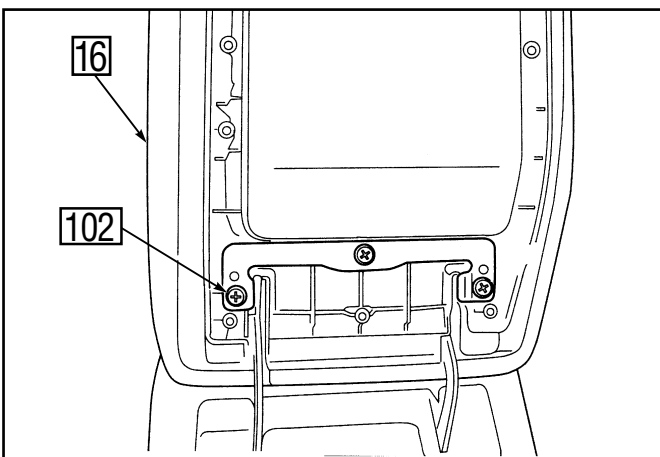

- 3.3 Remove the 3 Phillips screws **102** from the arm rest tray **16** and remove the tray.

**102**: Screw (3x)



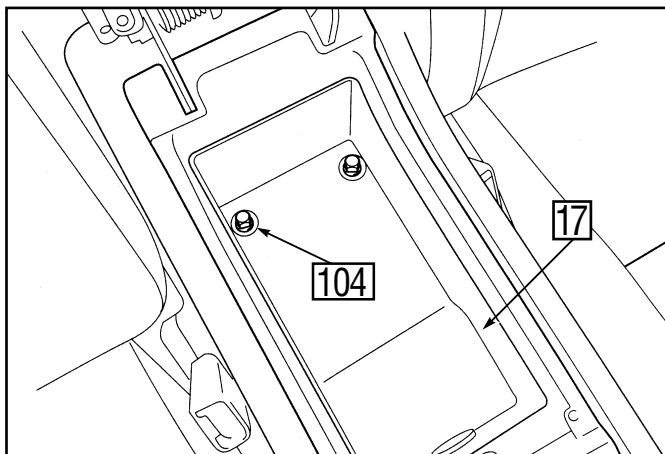

- 3.4 Remove the 2 Hexagonal bolts 104 from the lower console box 17.

104: Hexagonal bolt (2x)

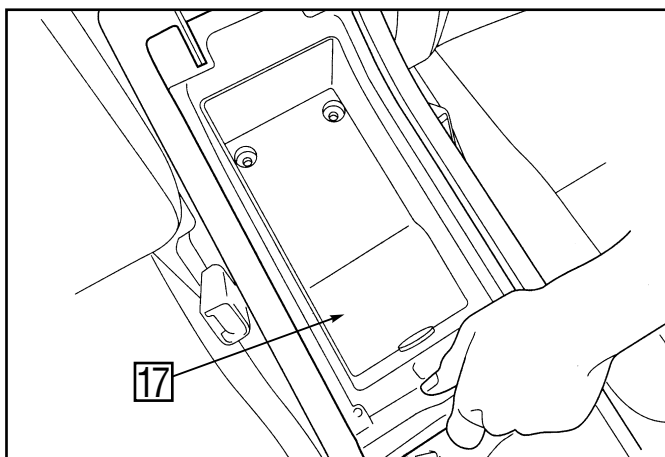

- 3.5 Remove the power socket (see HINT below) then grasp the lower console box 17 by the front edge and remove.

HINT:

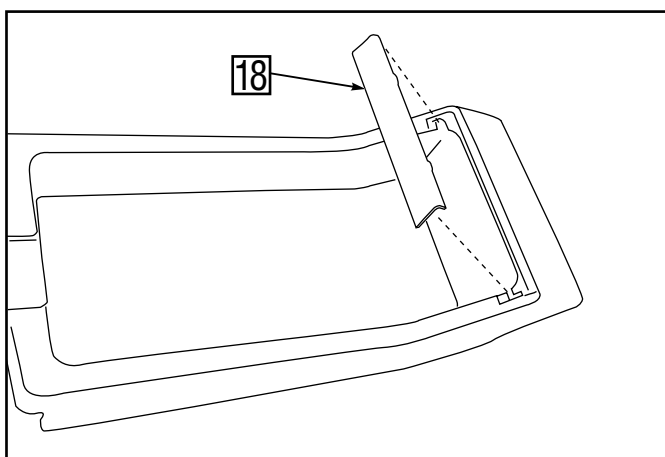
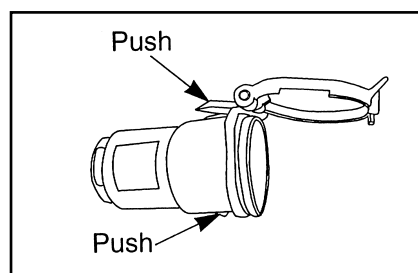

- 3.6 Remove the trimplate 18.

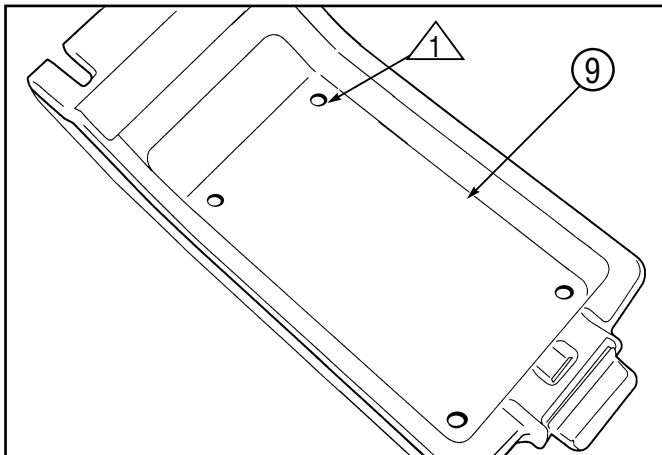

3.7

- a) Position the template ⑨ (supplied in the subkit) in the arm rest tray and mark the 4 holes  $\triangle 1$ .
- b) Drill 4 holes ( $\varnothing 6\text{mm}$ ) holes  $\triangle 1$ .

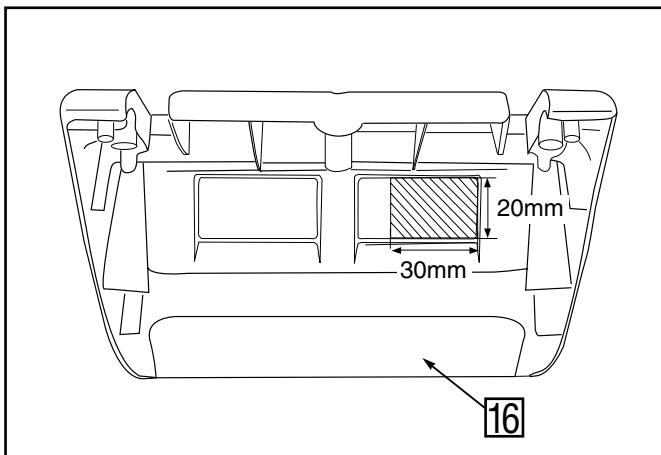

- 3.8 Using a utility knife, cut a rectangular hole (20 mm x 30 mm) in the arm rest tray 16, following the inscribed marks on the tray.

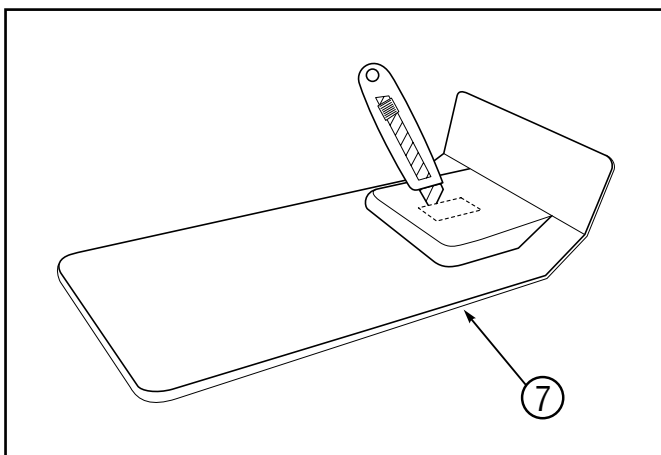

- 3.9 Locate the rectangular panel on the telephone tray ⑦ with the Lexus logo. Using a utility knife, remove the panel to make a rectangular hole (20 x 30 mm) in the telephone tray ⑦.

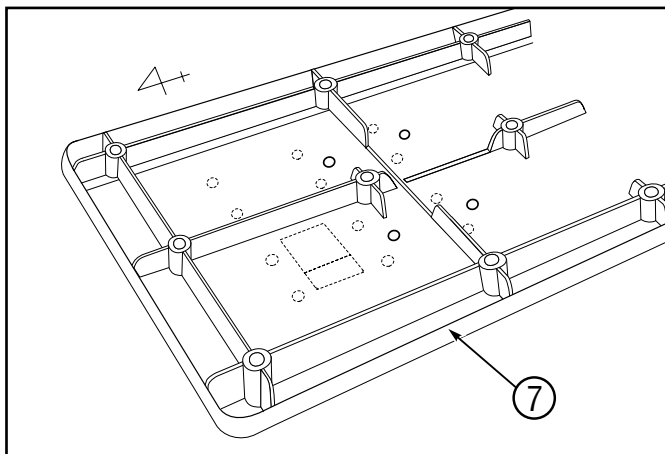

3.10 Punch the 4 holes in the telephone tray ⑦ as indicated in the drawing.

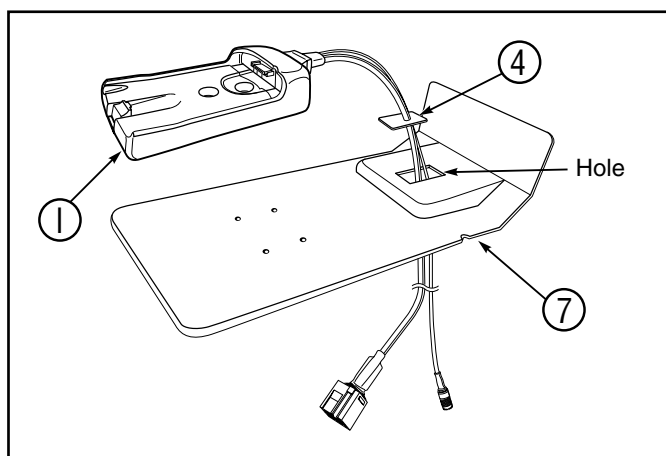

3.11 Route the 2 wires through the hole in the rubber grommet ④ and fit the grommet into the telephone tray hole.

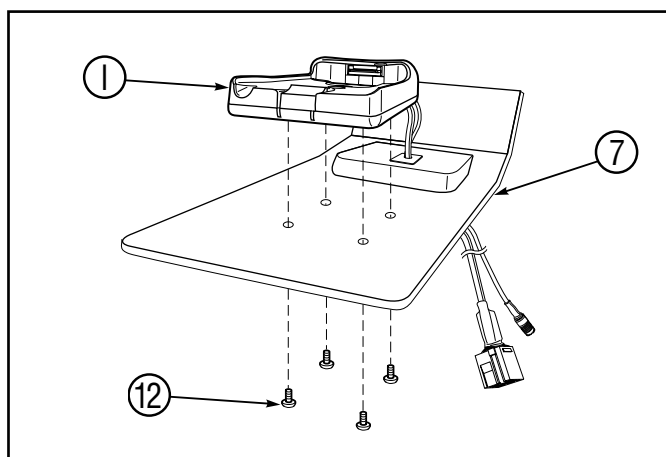

3.12 Fit the cradle ① to the telephone tray ⑦ using bolts ⑫.

⑫: Bolt (M5x6) (4x)

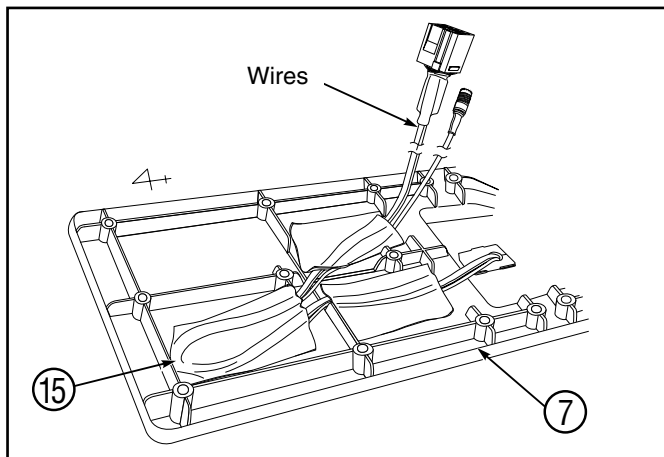

3.13 Route and tape the wires to the underneath of the telephone tray ⑦ as shown (HINT: eventually cut the foams ⑮ in half).

⑮: Foam (small)

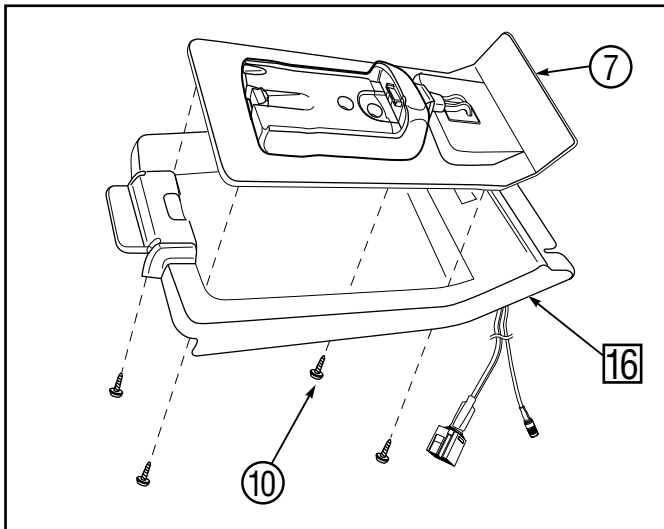

3.14

- a) Route the telephone and antenna wires through the arm rest tray 16.
- b) Fit the telephone tray ⑦ into the arm rest tray 16 using the 4 screws ⑩ provided in the kit.

⑩: Screw (4x)

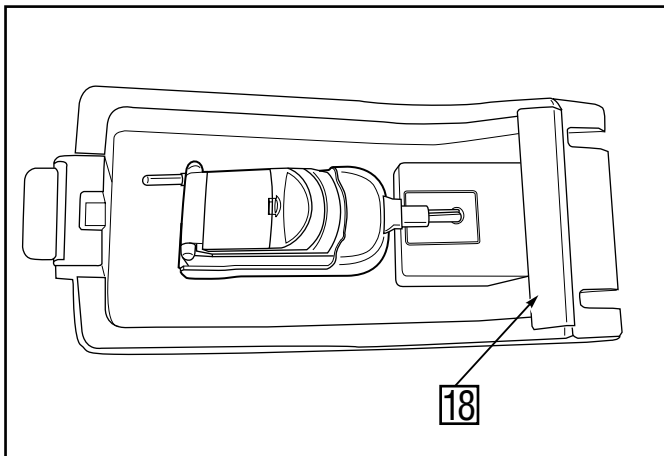

3.15 Refit the trimplate 18.

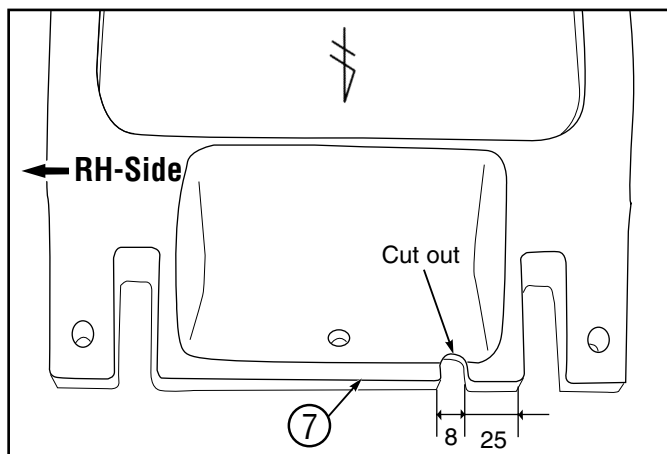

- 3.16 Using a file make a cut-out in the telephone tray cover ⑦ as shown.

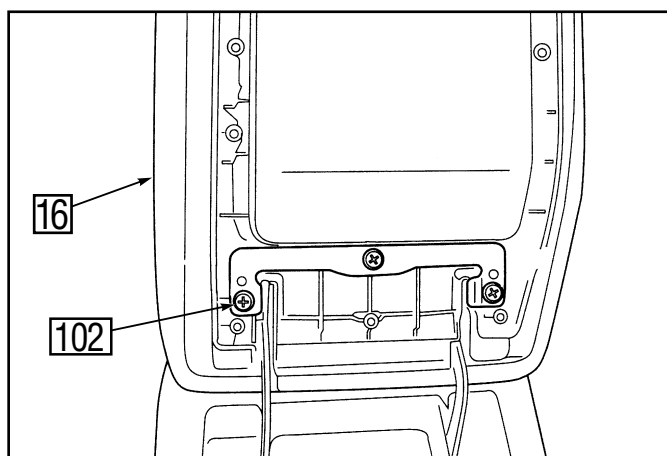

- 3.17 Refit the arm rest tray 16 to the vehicle using screws 102.

102: Screw (3x)

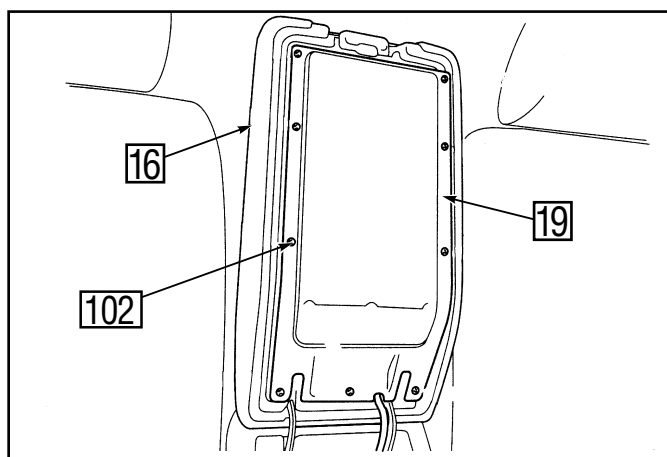

- 3.18 Refit the arm rest tray cover 19 to the arm rest tray 16 using screws 102.

102: Screw (9x)

Make sure to route the modular connector and antenna wires through the cut-out.

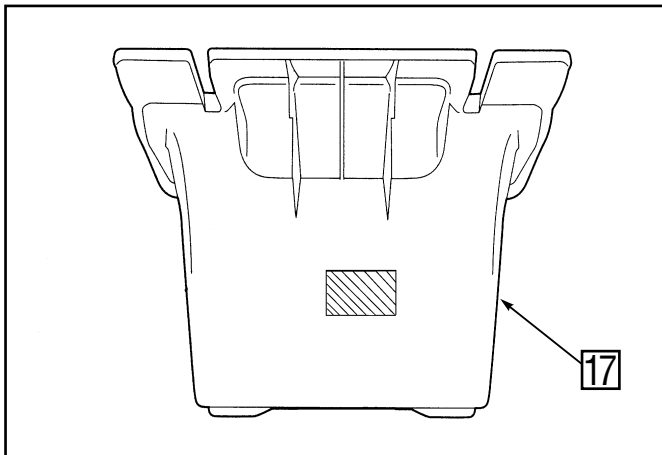

- 3.19 Using a utility knife, cut a 20 mm by 30 mm hole in the rear of the console box 17 following the existing inscribed out-line.

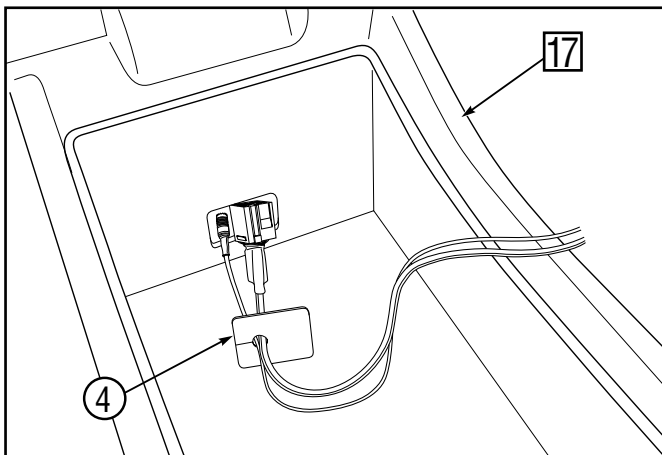

- 3.20 Fit the second rectangular rubber grommet ④ on the wires, then route the wires through the cut-out at the rear of the lower console box 17. Fit the grommet ④ into the cut-out.

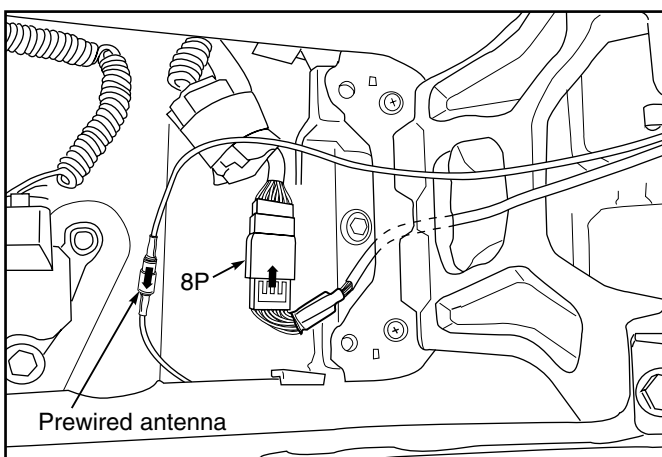

- 3.21
- In the midconsole area route the 8P-connector underneath the vehicle bracket and connect it to the vehicle prewired 8P connector.
  - Locate the prewired antenna connector in the midconsole area and connect the male and female connectors.

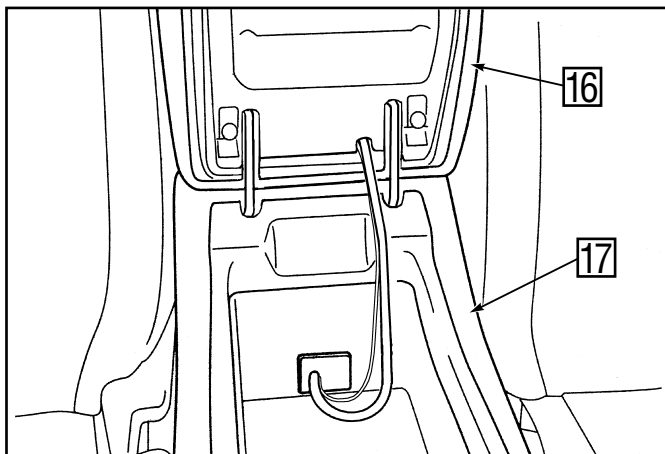

3.22

- a) Refit the lower console box 17 and the arm rest tray 16.
- b) Completely reassemble the centre console components, ensuring that the installation is noise- and rattle-free.

## 4. PSE INSTALLATION

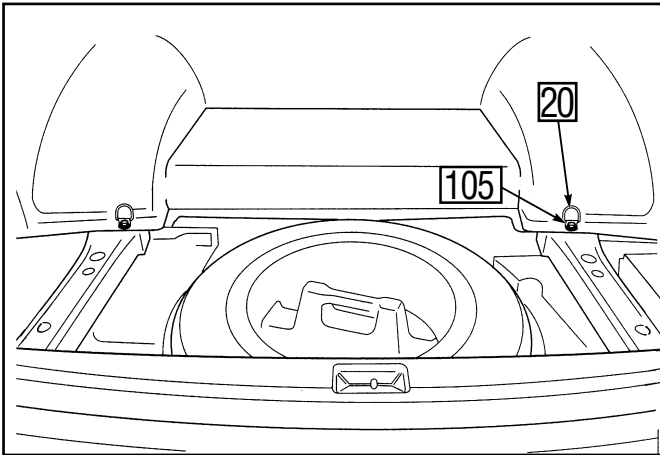

4.1

- a) Remove the carpet and flooring from the luggage compartment.
- b) Remove the bolt **105** from the front right D-ring tie-down **20**.

**105**: Bolt (1x)

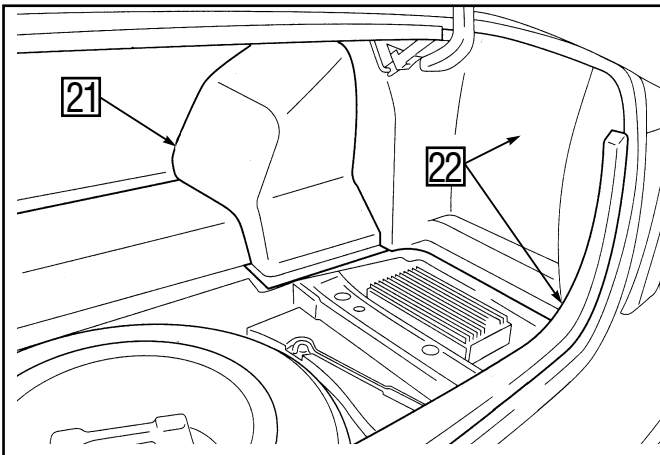

- 4.2 Remove the luggage compartment trim-plate, the front right **21** and right rear trims **22**.

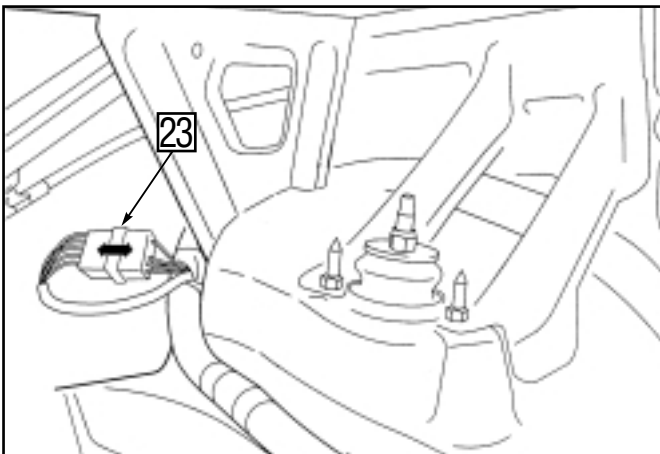

- 4.3 Locate and disconnect the 12P connector **23** in front of the righthand rear wheel arch.



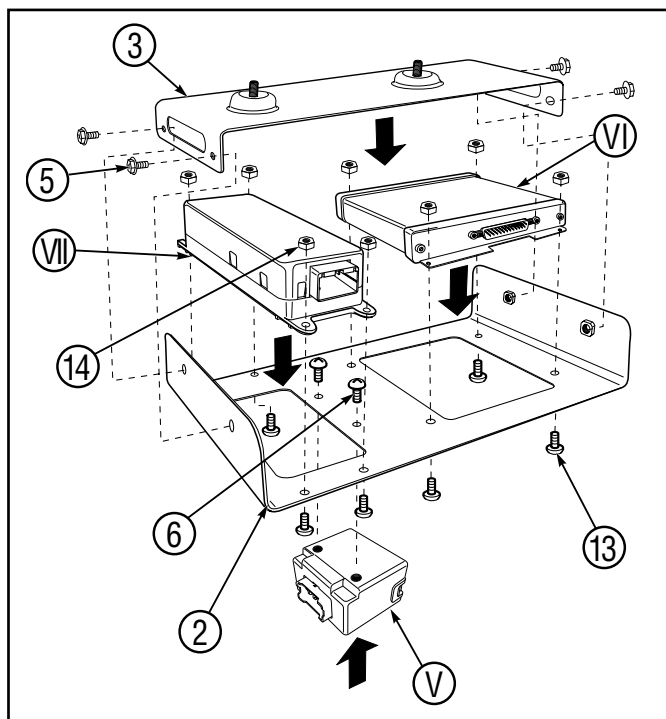

## 4.4

- a) Fit the PSE ⑥ and the universal controller ⑦ to the main bracket ② using bolts ⑬ and nuts ⑭. Ensure that the connections face in the same direction.  
⑬: Bolt (M4x12) (8x)  
⑭: Nut (M4) (8x)
- b) Fit the speaker relay ⑤ to the back of the main bracket ② using 2 bolts ⑥.  
⑥: Bolt (M4x5) (2x)
- c) Fit the support bracket ③ to the main bracket ② using the 4 bolts ⑤ provided in the subkit.  
⑤: Bolt (M4x6) (4x)

**IMPORTANT**

**Make sure the orientation of the connectors are as indicated in the drawing.**

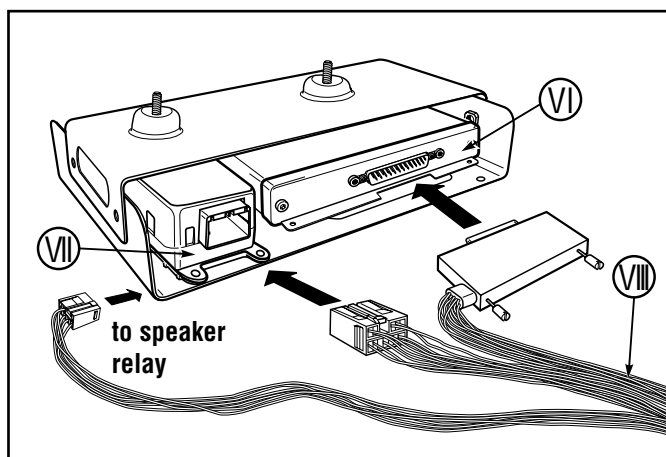

- 4.5 Connect the 25-pin connector to the PSE ⑥, the black 20-pin connector to the universal controller ⑦ and the white 10-pin connector to the speaker relay.

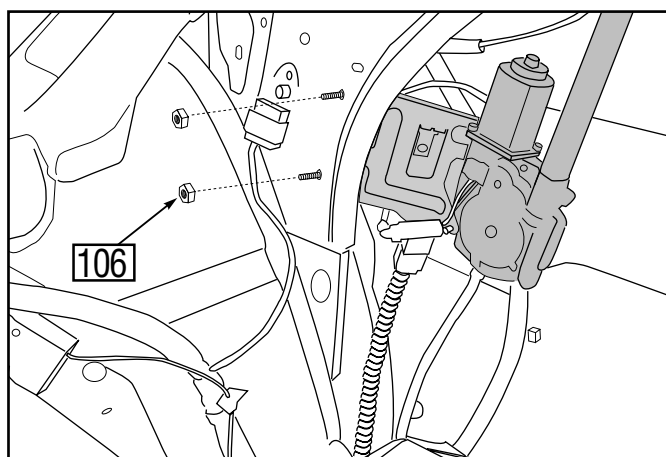

- 4.6 Remove the nuts ⑩⑥ to release the antenna assembly.

⑩⑥: Nut (2x)

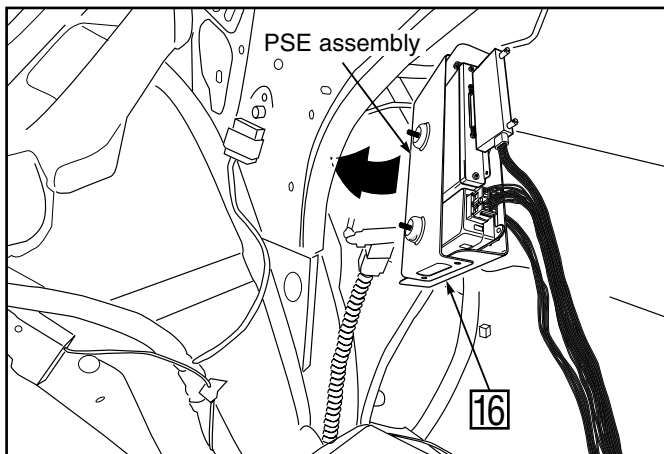

- 4.7 Insert the PSE assembly into the space between the outer and inner body panels.

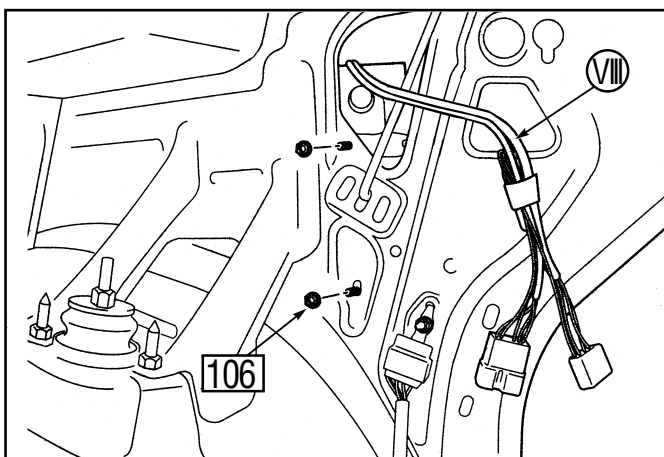

- 4.8
- Route the subwire adapter cable Ⅷ over the top of the PSE assembly and through the opening in the inner panel.
  - Position the PSE assembly by the 2 lugs of the mounting bracket projecting through the inner panel. Secure using 2 nuts 106.

106: Nut (2x)

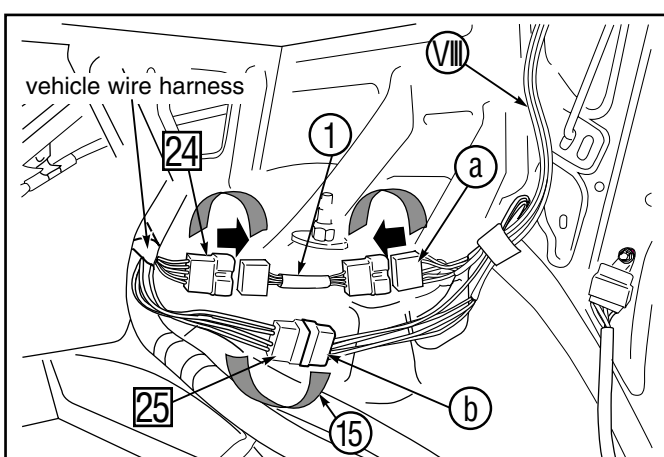

- 4.9

#### ATTENTION

**Be sure to follow these instructions very carefully.**

- Locate the two 12P connectors of the vehicle wire harness.
- Connect the conversion wire ① in between the subwire adapter cable 12P (female) connector ① and the vehicle wire harness 12P (male) connector 24.
- Connect the subwire adaptor cable 12P (male) connector ② to the vehicle wire harness 12P (female) connector 25.
- Wrap the connectors using foam 15 (3x).
- Refit luggage compartment trims, D-ring, carpets etc.

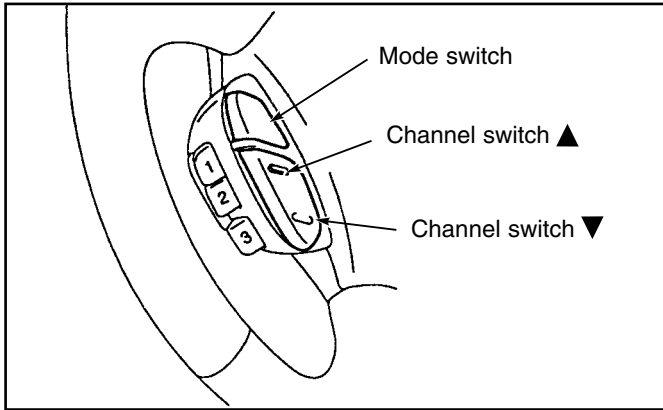

- 5.1 After the installation has been completed, the handsfree mode must be selected on the steering switches. This procedure is necessary to be able to use the handsfree mode. Perform the following steps.

### NOTE

Before performing this procedure check whether all vehicle functions are fully operational.

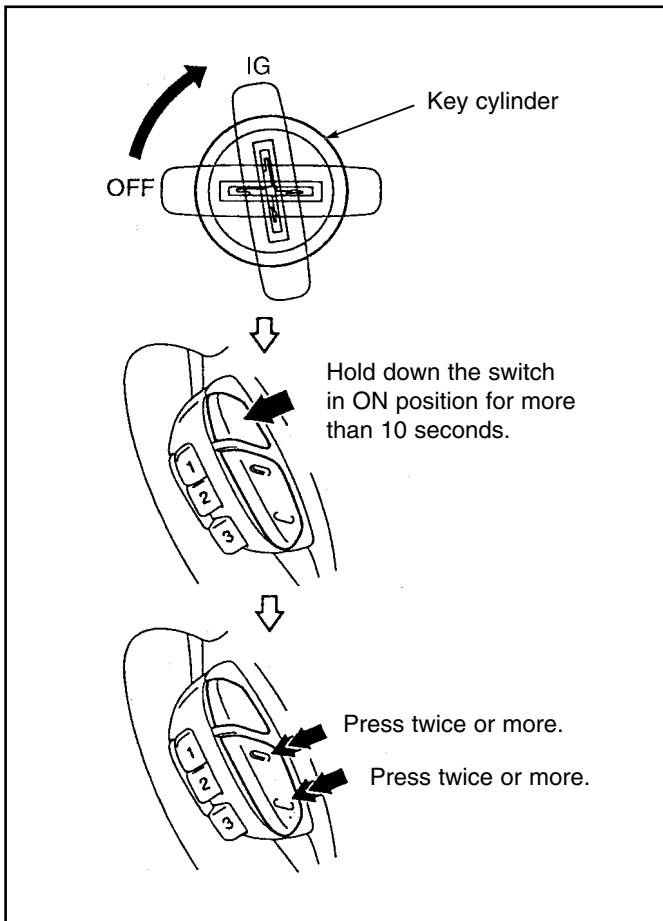

### 5.2 SELECTION PROCEDURE

- 1) Insert the key in the ignition switch and turn it from OFF to IG. Within 30 seconds thereafter, perform steps (2) and (3).
- 2) Hold down the MODE switch for more than 10 seconds.
- 3) Within 5 seconds
  - a) Press the channel switch ▲ twice or more.
  - b) Press the channel switch ▼ twice or more.

### NOTE

If the procedures have not been performed correctly, repeat steps (1) through (3) AFTER a delay of 30 seconds.

The same procedure must be performed when the switch case is to be removed. (E.g. When the Dual-Mode Mobile Phone system is removed from the vehicle and the audio switch is reinstalled).

- 5.3 Verify whether the steering wheel switches are operating.
- 1) Switch the ignition ON.
  - 2) Verify whether the phone is in its cradle and switched ON.
  - 3) Enter the PIN-code.
  - 4) Push any of the 4 buttons on the switch case: a confirmation tone should be heard.
  - 5) During a handsfree communication: the speaker volume can be raised and lowered by buttons ① and ②.
  - 6) If neither of the steps 4 and 5 operates please perform the "selection procedure" 5.2 again.

## 6. REASSEMBLY

## 7. PUTTING INTO SERVICE

---

### 6. REASSEMBLY

Reconnect the battery.

Test all functions.

Refit all parts.

### 7. PUTTING INTO SERVICE

Before returning the vehicle to the customer, test the phone for proper operation by following the instructions “**Getting Started**” in the Owner’s Manual.

In the event that the default language has to be changed, please select “language selection” in the **Phone setup menu** (page 58 in the Owner’s Manual).

